

FOR IMMEDIATE RELEASE

## VRcontext releases Walkinside™ 4.0

New version of leading real-time visualization software for the industry

Brussels, Belgium—October 25, 2005—VRcontext expands Walkinside™, the feature rich software for real-time visualization of complex 3D virtual models. Supporting cross disciplinary projects, Walkinside has become a component in major projects where interoperability across CAD systems and between project partners is vital, leading to improved project workflows and better asset lifecycle management.

VRcontext's contribution to the industry is the creation of a painless link between the engineering design activities and the long life cycle of critical & massive assets in terms of operations and maintenance, safety, training, simulations of potential incidents and remedies, all the way to decommissioning. Collaboration, full immersion and networking, allow for various disciplines to better understand, react, communicate & monitor the assets, globally.

Walkinside 4.0 is a major release delivering many new features, among which:

- ✿ The ability to connect objects to external documents or Web addresses. Users can easily add links to any objects. The link can be a Web address, a XML request, a document path name for Word, Excel, PDF, or even drawings from MicroStation or AutoCAD;
- ✿ The ability to convert large PDS projects in batch mode. This saves a lot of time and memory usage because the batch converter only converts files one by one and does not need to assemble all files as reference in one active model;
- ✿ The ability to create and run basic scenarios, containing walking characters, explosions, smoke, 3D sounds, etc. It is also possible to use internal software commands and modify the content of software variables;
- ✿ The ability to measure and access database without the need to process collision data, saving memory for very large projects;
- ✿ Added functionality for PDMS database support, multiple CAD formats and multiple exports merging capability.

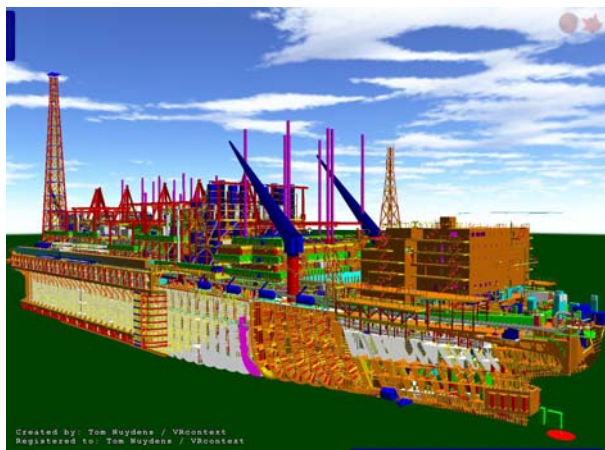

3D model courtesy of Petrobras

VRcontext has developed Walkinside 4.0 in close collaboration with its large Fortune 500 customer base by listening to their suggestions. Furthermore, VRcontext has added functionality deemed necessary to ensure Walkinside keeps its leading position in the industry.

Horst von Berg, Director of International Sales, says: "Walkinside has been in constant development over the past four years. We release version 4.0 with pride, because we know that the product we are shipping will benefit many clients. In addition, we know that Walkinside is used in VR centers, network sessions or stand alone, and such versatility for a single product is unique. Finally, if I have to single out a key feature, it is Walkinside's ability to create unified models by merging files coming from AEC CAD applications such as

MicroStation, PDS and PDMS, laser scanning output and MCAD applications such as CATIA, Unigraphics and SolidWorks. This functionality is revolutionizing the way project reviews can be conducted."

Press Release Walkinside 4.0 – October 2004

VRcontext s.a. / n.v.

Avenue Tedesco 7 – 1160 Brussels – Belgium  
[p] + 32 (0) 2 663 96 00 – [f] + 32 (0) 2 644 36 96  
[e] info@vrcontext.com – [w] www.vrcontext.com

Walkinside™  
explore the inside



Ref :660.017

© Copyright 2000-2005. All rights reserved

## About VRcontext (www.vrcontext.com)

VRcontext, headquartered in Brussels, Belgium, is a leading provider of real-time visualization and simulation solutions which are used worldwide in the Energy, Oil & Gas, Process, Shipbuilding, Aerospace, Manufacturing and Homeland Security & Defense sectors.

VRcontext delivers solutions based on a combination of its flagship products Walkinside and ProcessLife. Walkinside serves the needs of the engineering offices during the design and the construction phase of a project, whereas ProcessLife is a 7/24 operational tool for Owner/Operators throughout the whole lifecycle of the assets until their decommissioning.



## About Walkinside™ (www.walkinside.com)

Walkinside is the most powerful -yet very user friendly- software application for real-time visualization of complex 3D virtual models. The software is able to instantly render very large, complex, computer generated 3D models. Walkinside's patented Real-Time Collision Detection and Gravity Simulation technologies allow the users to immediately and effortlessly explore virtual reality generated models in contrast with other visualization applications which only offer a complicated, non-intuitive walkthrough.

Walkinside is the unavoidable tool for project reviews, staff training, virtual safety, security and maintenance drills in real-time, multi-users, LAN and Internet environments.

## About ProcessLife™ (www.processlife.com)

ProcessLife is a real-time data and information visualization solution which links seamlessly real-time Process Control, Process Simulation and Process Monitoring to the 3D virtual model of the most complex industrial assets.

It allows Owners/Operators to optimize their processes, monitor and easily locate visible and invisible assets, improve safety and training efficiency, reduce costly errors by improving reaction time in case of incidents.

ProcessLife has a suite of applications, each one specialized for specific purposes:

- Real-time DCS (Distributed Control Systems) or SCADA (Supervisory Control And Data Acquisition) data visualization
- Real-time CFD simulation
- Interfaces to document management applications, URLs, IE, manufacturing and maintenance data, etc.
- Subsea equipment monitoring tool and real-time ROV (Remotely Operated Vehicle) tracking for Offshore and Deep Water operations

ProcessLife is an enterprise-wide solution which can be customized for specific needs. It supports streaming servers, data servers, equipment preprocessors and workstation clients.

## More information

For more information, please contact:

Horst von Berg, Director International Sales at +32 (0) 2 663 96 00 or [h.vonberg@vrcontext.com](mailto:h.vonberg@vrcontext.com)

Or (incl. illustrations/artwork)

Jean-François Zeebroek, iMarcom Manager at +32 (0) 2 663 96 00 or [jf.zeebroek@vrcontext.com](mailto:jf.zeebroek@vrcontext.com)

Product information and specifications are subject to change without notice. This publication may contain inadvertent technical inaccuracies or typographical errors. VRcontext s.a./n.v. provides this information "as is" without warranty of any kind, either express or implied, including any implied warranties of merchantability or fitness for a particular purpose (this exclusion may not apply as some jurisdictions do not allow the exclusion of implied warranties).

All trade names referenced are the service mark, trademark, or registered trademarks of their respective manufacturers. Walkinside is a trademark of VRcontext s.a./n.v. AutoCAD is a registered trademark of Autodesk, 3ds MAX is a registered trademark of Discreet, a division of Autodesk, MicroStation is a registered trademark of Bentley, PDS is a registered trademark of Intergraph, PDMS is a registered trademark of AVEVA, CATIA and SolidWorks are registered trademarks of Dassault Systèmes, Pro/Engineer is a registered trademark of PTC, Unigraphics is a registered trademark of UGS, Word, Excel are trademarks of Microsoft.

Press Release Walkinside 4.0 – October 2004

**VRcontext s.a. / n.v.**

Avenue Tedesco 7 – 1160 Brussels – Belgium

[p] + 32 (0) 2 663 96 00 – [f] + 32 (0) 2 644 36 96

[e] [info@vrcontext.com](mailto:info@vrcontext.com) – [w] [www.vrcontext.com](http://www.vrcontext.com)

**Walkinside™**  
explore the inside



Ref :660.017

© Copyright 2000-2005. All right reserved